

Aisin AW TF-81SC*

*Also fits Ford (AF21) & Mazda (AW6A-EL).
Most of these kits also fit TF-80SC.

sonnax®

TIME TESTED • INDUSTRY TRUSTED®

1 Automatic Drive • P.O. Box 440 • Bellows Falls, VT 05101-0440 USA
(800) 843-2600 • (802) 463-9722 • F: (802) 463-4059 • www.sonnax.com

1 15741-29K
Lockup Clutch Control Valve Kit

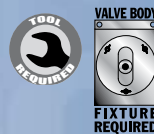

Helps cure:

- Converter remains applied causing harsh downshifts/RPM surging on coast
- Fluid overheat

Note: Requires tool kit F-15741-TL29 & the VB-FIX reaming fixture.

2 15741-53K
Lockup Clutch Control Plunger Valve Kit

Helps cure:

- Excess pressure in reverse
- Fluid & converter overheat

3 39741-01K
Oversized Main Pressure Regulator & Boost Valve Kit

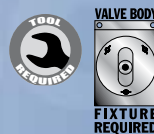

Helps cure:

- Excess pressure in reverse
- Fluid & converter overheat

Note: Requires tool kit F-39741-TL & the VB-FIX reaming fixture.

4 39741-11K
Secondary Pressure Regulator Valve Kit



Helps cure:

- High/Low SLT pressure
- Overheating bushings & converter

Note: Requires tool kit F-39741-TL11 & the VB-FIX reaming fixture.

5 39741-18K
Solenoid Modulator Valve Kit Fits either of 2 locations



Helps cure:

- DTC's P0734, P0735 or P0729
- Slippage or shock on kickdown

Note: Requires tool kit F-39741-TL18 & the VB-FIX reaming fixture.

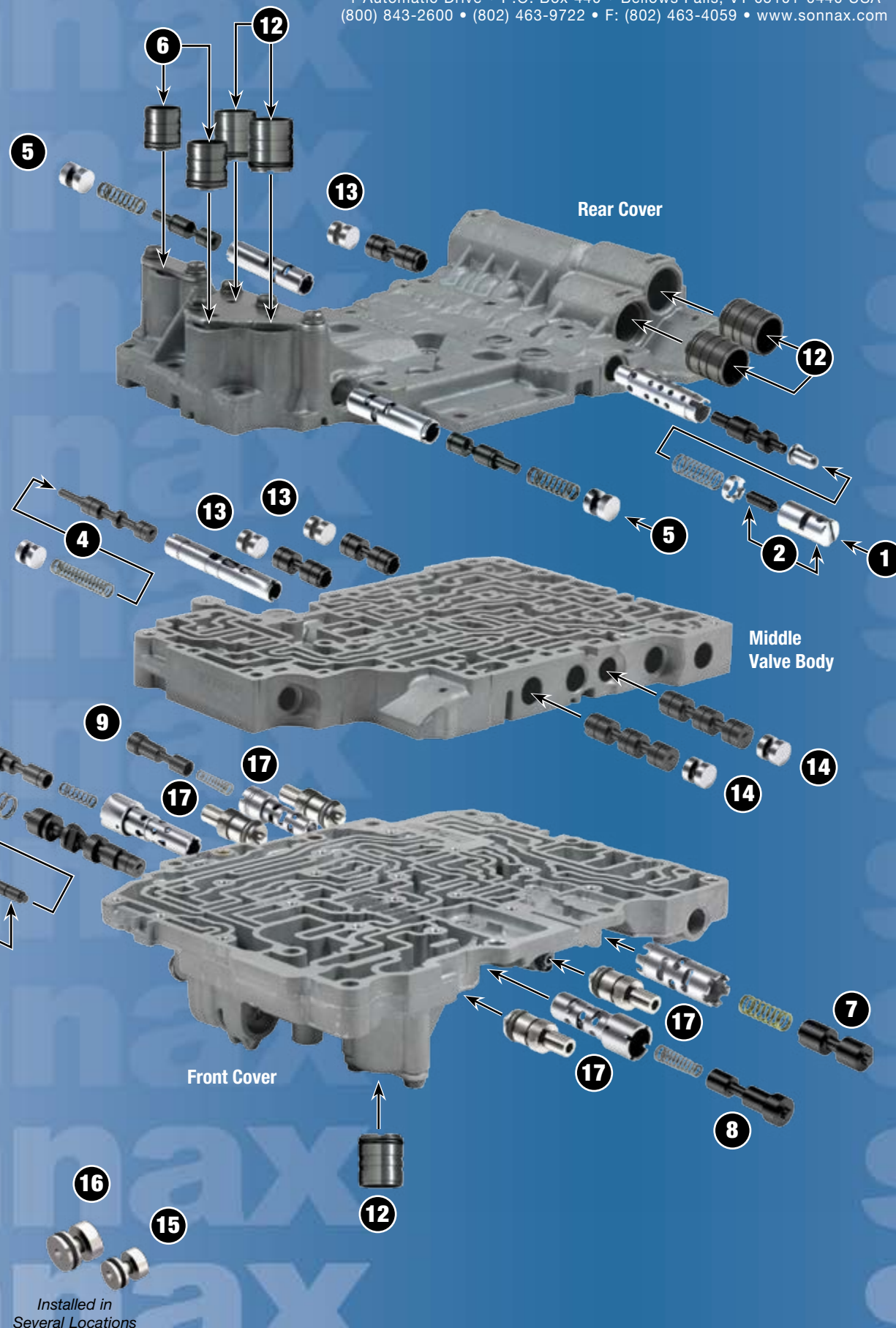

TF-80SC Valve Body

These kits except for 39741-14K also fit TF-80SC. See www.sonnax.com for bore locations.

6 39741-14K Fits either of 2 locations
Secondary Modulator Accumulator Piston Kit

Helps cure:

- Reduced throttle signal/solenoid feed oil pressure
- Shift complaints & codes

Note: This kit does not fit TF-81SC units.

7 15741-25K
C1/K1 Clutch Control Valve Kit

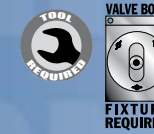

8 39741-05K
C2 Clutch Control Valve Kit



9 39741-08K
C3 Clutch Control Valve Kit



Helps cure:

- Flare upshifts
- Coast downshift bumps

Note: 15741-25K requires tool kit F-15741-TL25, 39741-05K & 39741-08K require tool kit F-39741-TL5 and all require the VB-FIX reaming fixture.

10 39741-44K
Boost Valve Kit

Helps cure:

- Delayed Reverse
- Low line pressure in Reverse

11 39741-22K
B1 Band Control Valve Kit

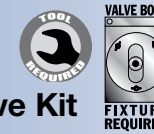

Helps cure:

- Harsh downshifts
- Flare on 1-2, 2-3 or 5-6

Note: Requires tool kit F-39741-TL22 & VB-FIX.

12 15741-14K
Accumulator Piston Kit

Can be used in any of 5 locations

Helps cure:

- Delayed engagements
- Slipping forward gears

13 15741-49K
Oversized Two-Spool Relay/Signal Valve Kit

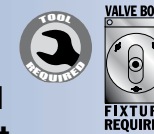

Fits any of 3 locations

14 15741-50K
Oversized Three-Spool Relay/Control Switch Valve Kit Fits either of 2 locations



Helps cure:

- Gear ratio & solenoid codes
- No shifts/various shift complaints

Note: Both kits require tool kit F-33741B-TL1 and the VB-FIX reaming fixture.

15 15741-35K 5 small, 9mm
16 15741-36K 5 large, 11mm
O-Ringed End Plug Kit

Helps cure:

- Various shift complaints

17 15741-48K
Spring Adjuster Kit Fits 4 locations

Helps cure:

- Slip, soft or long extended shifts
- Shift quality gets worse as temps rise